

**AUTOMA** AG54 (Dry) & AG55 (Oil Filled) with stainless steel crimped casing models are designed for corrosive environment where copper alloy is not suitable, and not highly viscosity or do not crystallize. Systems or equipment with pulsating pressure & vibration are apparent, the oil filled model is recommended.

### STANDARD SPECIFICATION

#### Dial Size (Nominal Diameter)

63mm (2.5"); 100mm (4")

#### Connection

63mm : 1/8", 1/4" BSPT/ BSPF/ NPT  
 100mm: 3/8", 1/2" BSPT/ BSPF/ NPT

#### Scale Range (kgf/cm<sup>2</sup>, psi, bar)

-1 bar ~ 0 to 0 ~ 600 bar

#### Accuracy

± 1.6% of Full Scale

#### Working Pressure

Steady : 75% of Full Scale  
 Over Range Protection: 130% of F.S

#### Protection Class

IP65

#### Working Temperature

Ambient : -20 ~ 65°C  
 Fluid : Max 80°C

#### Blow Protection

Top disc

#### Options

Oil Filled  
 Adjustable Pointer  
 Damper Movement  
 Maximum pointer  
 Red Pointer

#### Material

Case & Cover : Crimped, SS304  
 Connection : SS316  
 Movement : SS304  
 Dial Plate : White Aluminum  
 Pointer : Aluminium alloy, Black painted  
 Oil Filling : Glycerin oil/ Silicon oil(option)  
 Window : 63mm - P.C  
 : 100mm - Tempered Glass

#### Element

SS316 (100mm)  
 <100bar : C type Bourdon Tube  
 ≥100bar : Helical Type Bourdon Tube  
 SS316 (63mm)  
 <60bar : C type Bourdon Tube  
 ≥60bar : Helical Type Bourdon Tube

### ORDERING INFORMATION

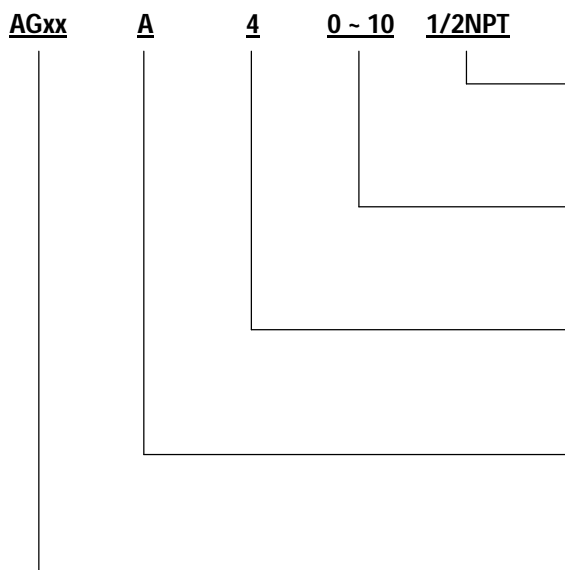

#### Connection:

1/8", 1/4", 3/8", 1/2" (BSPT/ BSPF/ NPT)

#### Range:

-1~0, 0~1, 0~2, 0~3, 0~4, 0~6, 0~10, 0~16, 0~20  
 0~25, 0~35, 0~40, 0~50, 0~60, 0~70, 0~100  
 0~160, 0~250, 0~350, 0~400, 0~500, 0~600  
 (mmHg; kgf/cm<sup>2</sup> & psi; bar & psi; Mpa)

#### Dial Size:

4" = 100mm; 2.5" = 63mm

#### Mounting Type:

CODE A; CODE B; CODE D; CODE BD; CODE BDC

#### Model:

AG54: Dry type  
 AG55: Oil filled type

#### Example of Order

**AG54 - A - 4" - 0~10 bar&psi - 1/2"NPT**

**BASIC DIMENSIONS**

**CODE A**

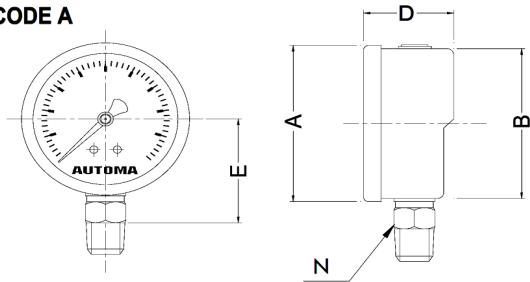

<b>A: Direct bottom connection</b>		<i>Unit: mm</i>
	<b>ø 63</b>	<b>ø 100</b>
<b>A</b>	71.0	112.0
<b>B</b>	62.7	103.5
<b>D</b>	36.3	33.2
<b>E</b>	43.0	66.7
<b>N</b>	14.0	22.0

**CODE B**

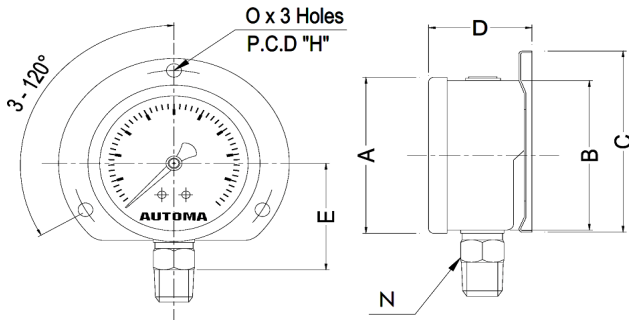

<b>B: Bottom connection with surface mounting flange</b>		<i>Unit: mm</i>
	<b>ø 63</b>	<b>ø 100</b>
<b>A</b>	71.0	112.0
<b>B</b>	62.7	103.5
<b>C</b>	79.0	122.0
<b>D</b>	39.2	34.2
<b>E</b>	43.0	66.7
<b>H</b>	78.4	117.5
<b>N</b>	14.0	22.0
<b>O</b>	4.3	6.0

**CODE D**

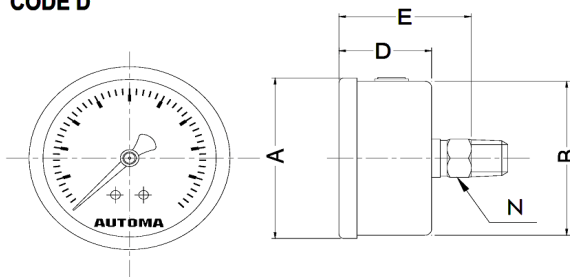

<b>D: Direct center back connection</b>		<i>Unit: mm</i>
	<b>ø 63</b>	
<b>A</b>	71.0	
<b>B</b>	62.7	
<b>D</b>	36.0	
<b>E</b>	51.0	
<b>N</b>	14.0	

**CODE BD**

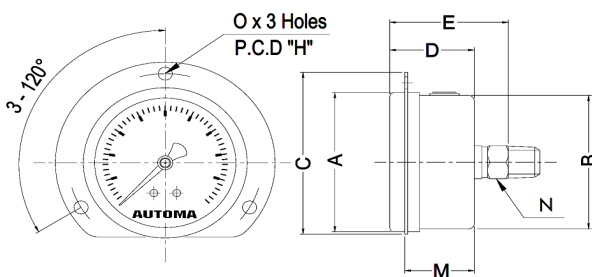

<b>BD: Center back connection with panel mounting</b>		<i>Unit: mm</i>
	<b>ø 63</b>	
<b>A</b>	71.0	
<b>B</b>	62.7	
<b>C</b>	87.6	
<b>D</b>	36.0	
<b>E</b>	51.0	
<b>H</b>	78.4	
<b>M</b>	26.0	
<b>N</b>	14.0	
<b>O</b>	4.3	

**CODE BDC**

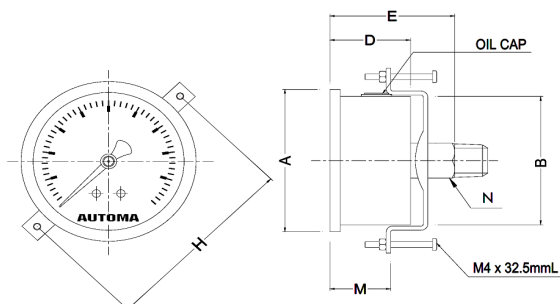

<b>BDC: Center back connection with clamp</b>		<i>Unit: mm</i>
	<b>ø 63</b>	
<b>A</b>	71.0	
<b>B</b>	62.7	
<b>D</b>	36.0	
<b>E</b>	51.0	
<b>H</b>	82.0	
<b>M</b>	27.0	
<b>N</b>	14.0	
<b>O</b>	4.3	

*Unit: mm*

The specification and dimensions are subject to change without prior notice!