

SEAT	NBR	EPDM	VITON	PTFE	SILICON
Temp. °C	-10~80	-15~120	-20~150	-20~180	-50~200

NO.	PART NAME	MATERIAL	
		ACM	ACM6
1	Body	CAST IRON	
2	Disc	A351 Gr.CF8	A351 Gr.CF8M
3	Lower stem	SS416	
4	Seat	NBR / EPDM / VITON (*)	
5	Upper stem	SS416	
6	Lock pin	AISI 1066	
7	Lower O-ring	NBR / EPDM / VITON (*)	
8	Bushing	PTFE	
9	O-ring	NBR / EPDM / VITON (*)	
10	Bushing	PTFE	
11	Half ring	SS416	
12	Retainer ring	Spring steel	
13	Rivet	Aluminum	
14	Nameplate	Aluminum	

The new body design offers esthetic appearance, strength and compatible flange connection to international standards. Its top flange is designed to ISO5211 for the direct mounting of gear operator or pneumatic or electric actuators which eliminate the cost of mounting bracket. The one piece design body provides outstanding protection against particle entrapment and bacterial growth.

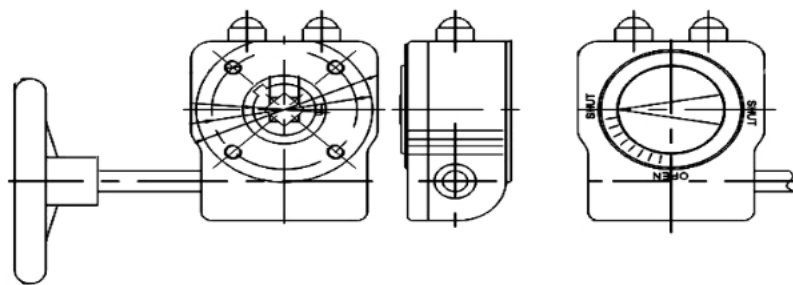
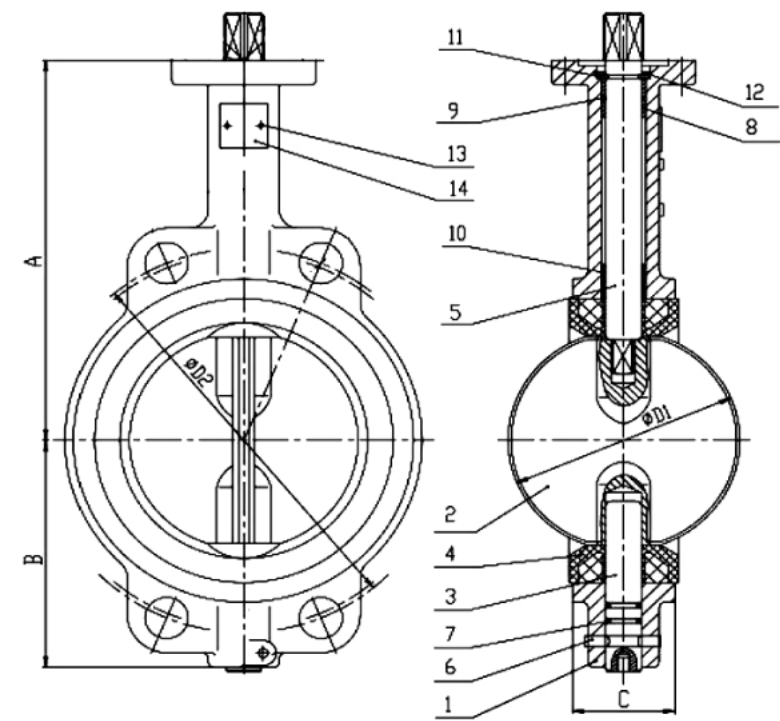

Gear box #ACMG (*)

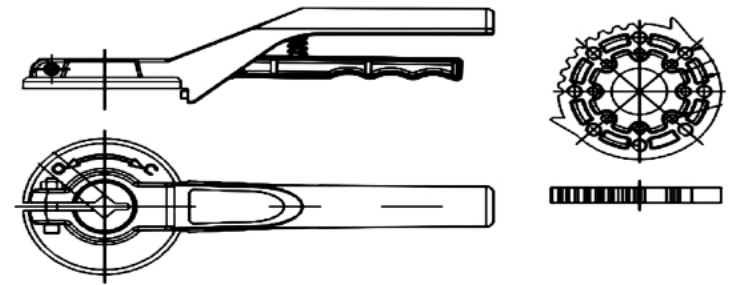

#ACML handle lever (*)

(*) Optional

DIMENSIONS

SIZE		UNIVERSAL FLANGE END					Key	ISO 5211	OPERATOR	
INCH	DN	A	B	C	Ø D1	Ø D2			#ACML	#ACMG
1-1/2"	40	136	69	33	43	106	9	F05/F07	# 09	# 09
2"	50	156	80	43	53	120	9	F05/F07	# 09	# 09
2-1/2"	65	162	89	46	65	136	9	F05/F07	# 09	# 09
3"	80	170	95	46	79	155	11	F05/F07	# 11	# 11
4"	100	185	114	52	104	183	11	F05/F07	# 11	# 11
5"	125	207	127	56	123	213	14	F05/F07	# 14	# 14
6"	150	216	139	56	156	238	14	F05/F07	# 14	# 14
8"	200	256	175	60	203	296	17	F07/F10	# 17	# 17
10"	250	248	203	68	251	357	22	F10/F12	n/a	# 22
12"	300	280	242	78	302	417	22	F10/F12	n/a	# 22
14"	350	368	267	78	334	476	22	F10/F12	n/a	# 22
16"	400	400	297	102	390	540	27	F14	n/a	# 27